

REVISIONS		
NO.	DESCRIPTION	DATE

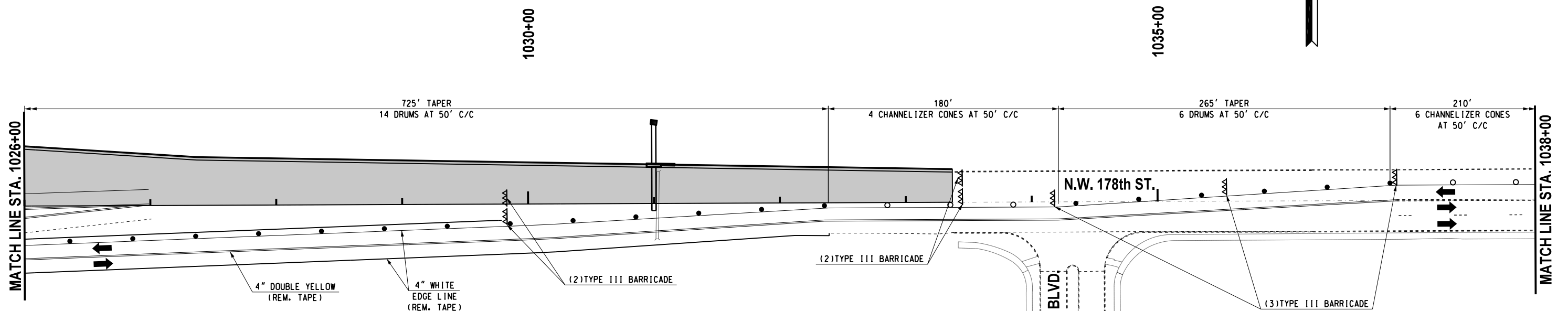
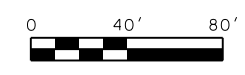

ALL PAVEMENT MARKINGS
SHALL BE REMOVABLE
TAPE

CONTRACTOR SHALL KEEP
11' MINIMUM LANES UNLESS
OTHERWISE NOTED.

CONTRACTOR TO PROVIDE
ACCESS TO ALL DRIVEWAYS
DURING CONSTRUCTION.

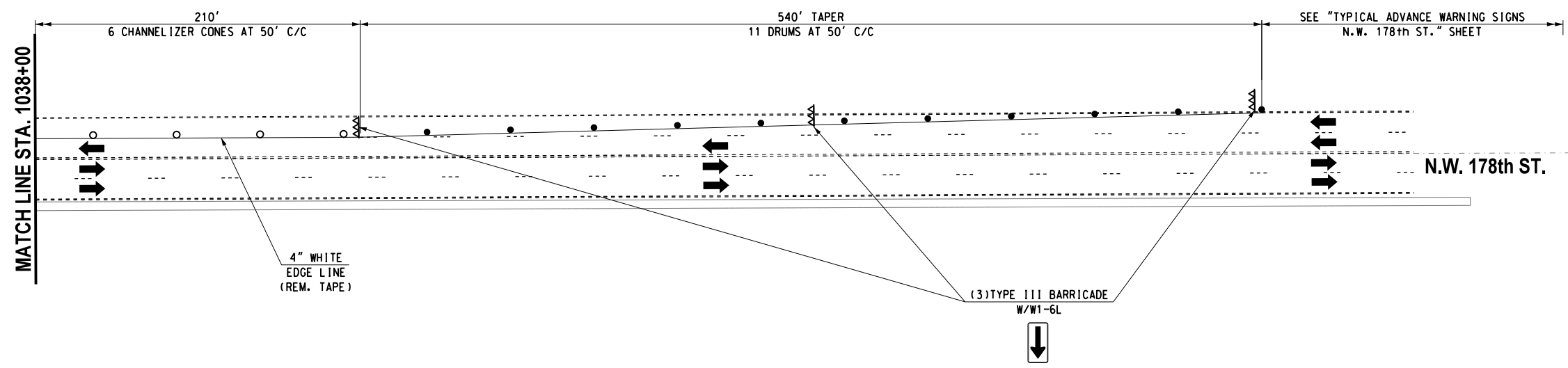

LEGEND	
	- TYPE III BARRICADE W/ TWO TYPE "A" LIGHTS
	- DRUM
	- CHANNELIZER CONE
	- PORTABLE CONC. BARRIER WALL
	- CONSTRUCTION ZONE IMPACT ATTENUATOR
	- WORK AREA

Design	RWR	08/10/17
Drawn	GDB	08/10/17

TRAFFIC CONTROL
PHASES 3J & K (SHEET 2 OF 2)
N.W. 178th ST.
State Job No. 14964(08) Sheet No. T69

08/10/17 G:\0\Projects\T-1662B SH 74 @ NW 178th, NW 192nd & NW 206th\CAD\TC PHASE 3J,K,2 NW 178th.dgn